

A30 Chiverton to Carland Cross TR010026

2.2(C) LAND PLANS

Planning Act 2008

APFP Regulation 5(2)(i)(i),(ii),(iii)
Infrastructure Planning (Applications: Prescribed
Forms and Procedure) Regulations 2009

Volume 2

June 2019

Contents

1. LAND PLANS KEY PLAN
2. LAND PLANS SHEET 1 OF 10
3. LAND PLANS SHEET 2 OF 10
4. LAND PLANS SHEET 3 OF 10
5. LAND PLANS SHEET 4 OF 10
6. LAND PLANS SHEET 5 OF 10
7. LAND PLANS SHEET 6 OF 10
8. LAND PLANS SHEET 7 OF 10
9. LAND PLANS SHEET 8 OF 10
10. LAND PLANS SHEET 9 OF 10
11. LAND PLANS SHEET 10 OF 10

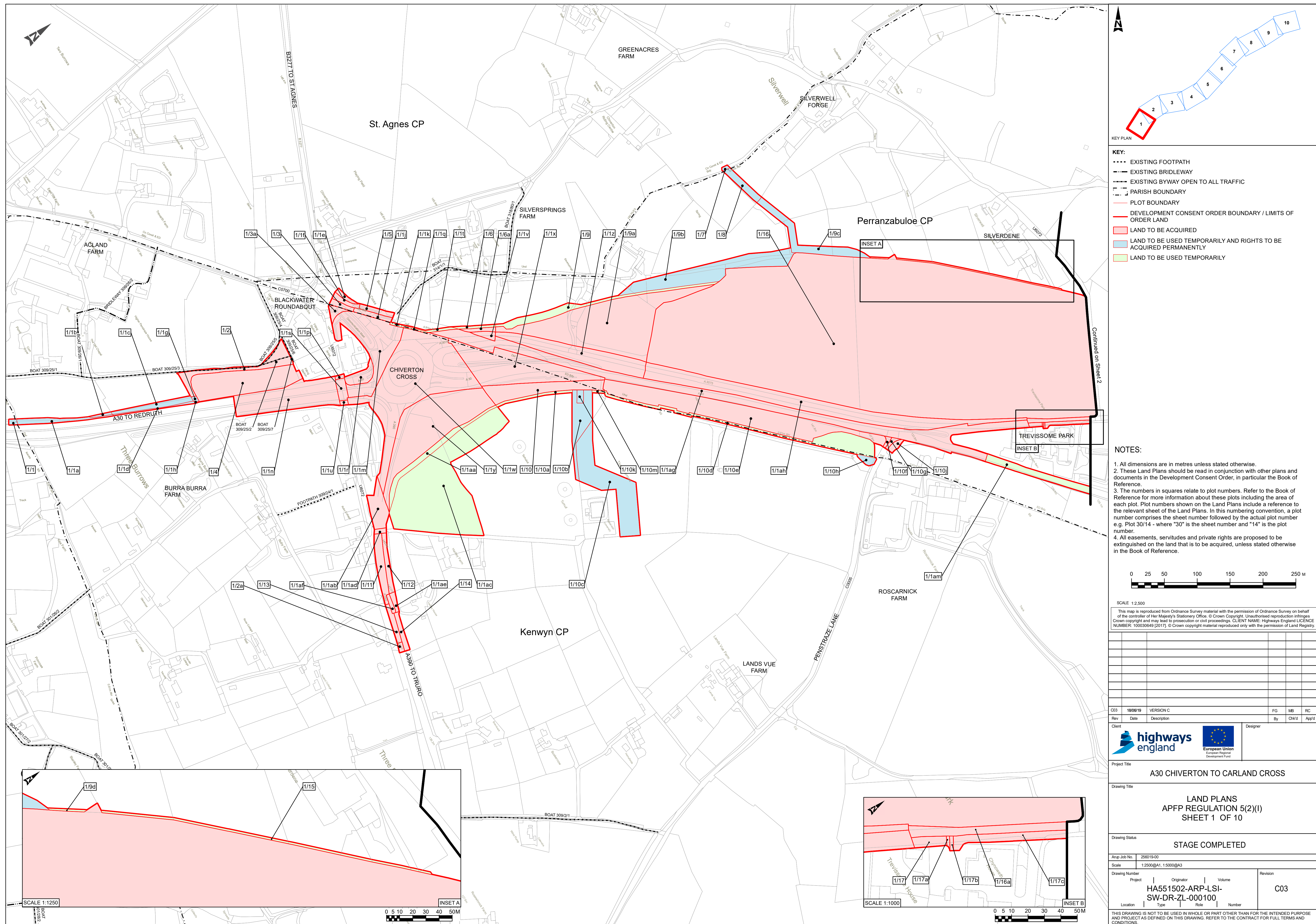

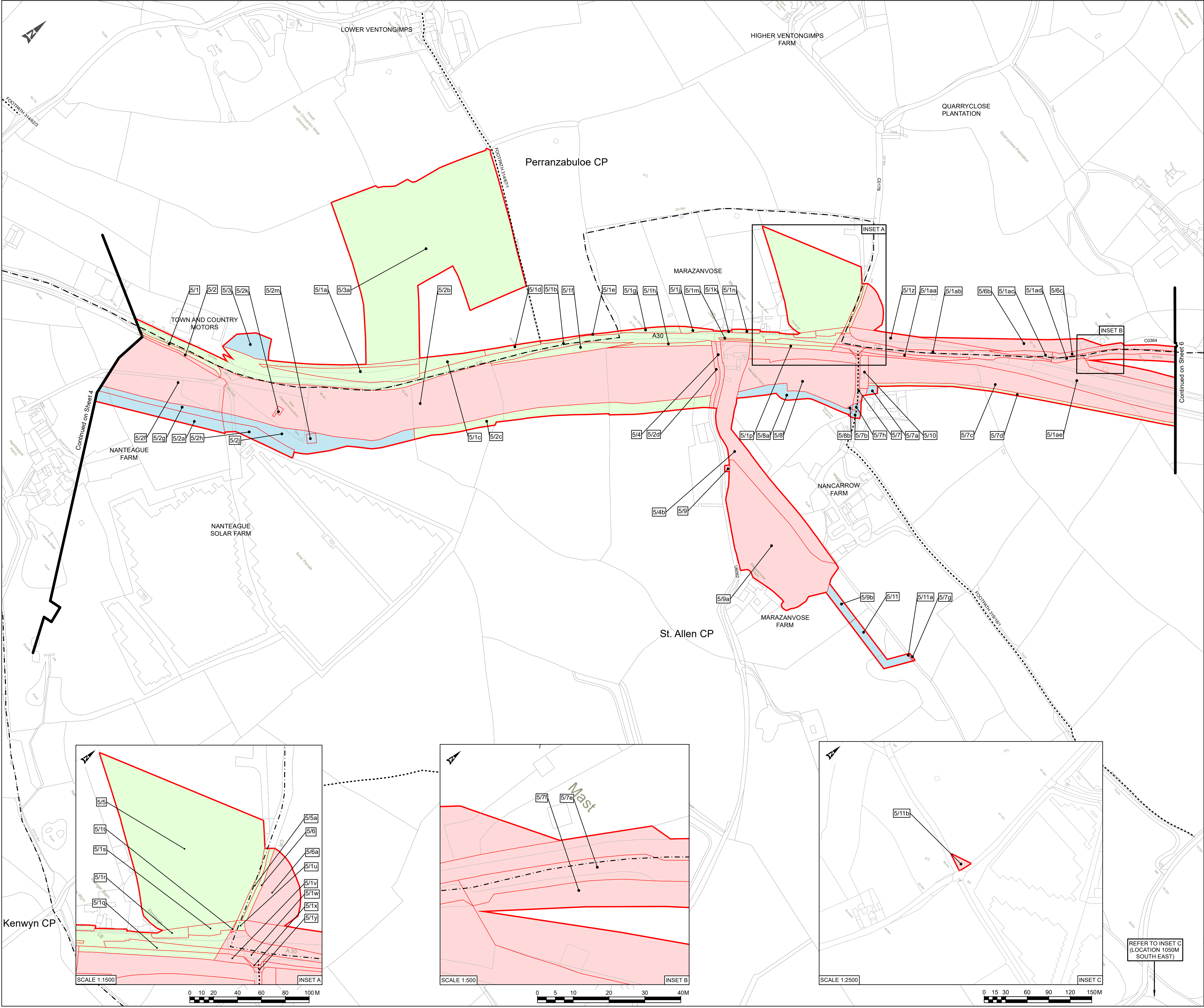

KEY:

- EXISTING FOOTPATH
- PARISH BOUNDARY
- PLOT BOUNDARY
- DEVELOPMENT CONSENT ORDER BOUNDARY / LIMITS OF ORDER LAND
- LAND TO BE ACQUIRED
- LAND TO BE USED TEMPORARILY AND RIGHTS TO BE ACQUIRED PERMANENTLY
- LAND TO BE USED TEMPORARILY

NOTES:

- All dimensions are in metres unless stated otherwise.
- These Land Plans should be read in conjunction with other plans and documents in the Development Consent Order, in particular the Book of Reference.
- The numbers in squares relate to plot numbers. Refer to the Book of Reference for more information about these plots including the area of each plot. Plot numbers shown on the Land Plans include a reference to the relevant sheet of the Land Plans. In this numbering convention, a plot number comprises the sheet number followed by the actual plot number e.g. Plot 30/14 - where "30" is the sheet number and "14" is the plot number.
- All easements, servitudes and private rights are proposed to be extinguished on the land that is to be acquired, unless stated otherwise in the Book of Reference.

0 25 50 100 150 200 250 M

SCALE 1:2,500

This map is reproduced from Ordnance Survey material with the permission of Ordnance Survey on behalf of the controller of Her Majesty's Stationery Office. © Crown Copyright. Unauthorised reproduction infringes Crown copyright and may lead to prosecution or civil proceedings. CLIENT NAME: Highways England LICENCE NUMBER: 100030649 (2017). © Crown copyright material reproduced only with the permission of Land Registry.

| Rev | Date | Description | By | Chkd | App'd |
|-----|----------|-------------|----|------|-------|
| C03 | 19/06/19 | VERSION C | | | |

Client: highways england

Project Title: A30 CHIVERTON TO CARLAND CROSS

Drawing Title: LAND PLANS
APFP REGULATION 5(2)(I)
SHEET 5 OF 10

Drawing Status: STAGE COMPLETED

App. Job No.: 256019-00

Scale: 1:2500@A1, 1:5000@A3

Drawing Number: HA551502-ARP-LSI-SW-DR-ZL-000104

Location: Type: Role: Number: C03

THIS DRAWING IS NOT TO BE USED IN WHOLE OR PART OTHER THAN FOR THE INTENDED PURPOSE AND PROJECT AS DEFINED ON THIS DRAWING. REFER TO THE CONTRACT FOR FULL TERMS AND CONDITIONS.

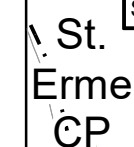

| | | | |
|--|------|------|--------|
| SW-DR-ZL-000109 | | | |
| Location | Type | Role | Number |
| THIS DRAWING IS NOT TO BE USED IN WHOLE OR PART OTHER THAN FOR THE INTENDED PURPOSE AND PROJECT AS DEFINED ON THIS DRAWING. REFER TO THE CONTRACT FOR FULL TERMS AND CONDITIONS. | | | |

If you need help accessing this or any other Highways England information,
please call **0300 123 5000** and we will help you.